



**ACCESSORY STORAGE BUILDING
MOUNT CREST COURT
GREATER DAYTON PREMIER MANAGEMENT**

ADDENDUM 02

April 30, 2026

Greater Dayton Premier Management
400 Wayne Ave.
Dayton, Ohio 45410

This Addendum modifies and shall become a part of the original Contract Documents and is hereby made part of the Bidding Documents for the referenced project.

All bidders shall indicate in their bid/proposal that this Addendum has been received and considered in their bid proposal.

The Addendum items are intended to supplement, clarify or correct parts of the bid proposal package. Items in the addendum shall take precedence over items corrected and shall be of equal value with items supplemented or clarified. Any questions in reference to this addendum must be directed, in writing, to:

Jonathan Schaaf
RDA Group Architects
7662 Paragon Road
Dayton, Ohio 45459
937.610.3440
JRS@rda-group.com

ADDENDUM ITEMS

1. Drawing Sheet E1.1 and E4.1: REPLACE original drawing sheet with the updated sheet attached to this addendum. This adds power to the overhead door.
2. CLARIFICATION: The exact transformer which the proposed electric service will be extended from is up to the utility company. The electrical contractor should fill out a construction packet to get an engineer from the utility assigned to their project to get this finalized. If 3 phase power is not available for a reasonable "aid to construction" cost, L2 will coordinate preparation of revised drawings to reflect a single phase service.

End of Addendum #2.

LIGHTING FIXTURE SCHEDULE																			
FIXTURE SYMBOL	FIXTURE VOLTAGE	FIXTURE INPUT WATTS	TEMPERATURE (K)	DELIVERED LUMENS	MANUFACTURER AND MODEL NUMBER	OTHER ACCEPTABLE MANUFACTURER	DIFFUSER MEDIA	CLASSIFICATION	TRIM COLOR					MOUNTING	SIZE (IN.)			NOTES	
									WHITE	NICKEL	BLACK	BRUSHED NICKEL	STANDARD		SEE NOTE	DIAMETER OR WIDTH	LENGTH		DEPTH
A1	120	27.5	4000K	3,659	#CPX-2X2-3200LM-40K-M4	AS PRE-APPROVED	POLYCARBONATE	N	X						CS	23.8"	23.8"	1.7"	1
F1	120	26	4000K	4,123	#WPCM-4L-U-40-T3- BLK-SP1	AS PRE-APPROVED	POLYCARBONATE	N		X					WM-11'-0"	18.25"	9.1"	13.75"	2
X1	-	-	-	-	COMPASS #CCR	AS PRE-APPROVED	EMERGENCY EGRESS	EM	X						UNIVERSAL	19.25	8.125	1.75	-
ER	-	-	-	-	COMPASS #CORS	AS PRE-APPROVED	EMERGENCY EGRESS	EM	X						WM-8'-0"	4.5	DIA	6.7	-
W	-	-	-	-	COMPASS #CU2	AS PRE-APPROVED	EMERGENCY EGRESS	EM	X						WM-8'-0"	4	9	2.75	-

NOTES:
1. EC TO PROVIDE 2X2SMKSH FOR SYRFACE MOUNTING KIT.
2. EC TO PROVIDE A PHOTOCCELL TO CONTROL EXTERIOR LIGHTING. REFER TO SHEET E1.1 FOR FURTHER INFORMATION.

- DRAWING NOTES**
- PROVIDE PHOTOCCELL CONTROL FOR EXTERIOR LIGHTING. MOUNT SENSOR ON THE NORTH SIDE OF BUILDING. CONTRACTOR TO ADJUST SENSOR FOR PROPER OPERATION.
 - RECEPTACLES TO BE MOUNTED AT 48" AFF
 - PROVIDE CEILING MOUNTED OUTLET TO SERVE OVERHEAD DOOR OPERATOR. COORDINATE EXACT LOCATION AT SITE PRIOR TO ROUGH IN. COORDINATE ALL CONTROL WIRING WITH GARAGE DOOR CONTRACTOR.

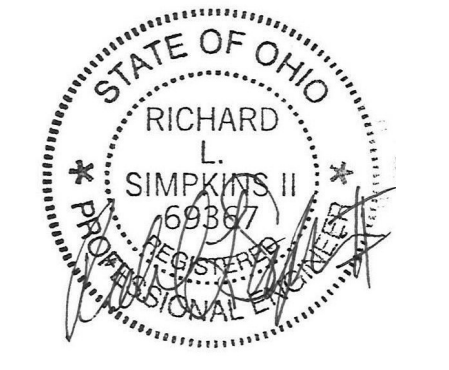

RDA GROUP ARCHITECTS
7662 PARAGON ROAD | DAYTON, OH 45459 | 937.610.3440



Accessory Storage Building:
Mount Crest Court
700 Mount Crest Court
Dayton, Ohio 45403

PLAN SYMBOL	DESCRIPTION/LOCATION	LOAD CHARACTERISTICS					STARTER					DISCONNECT				CTRL DEVICE			PANEL	CIRCUIT	FEEDER SIZE/RACEWAY	NOTES	PLAN SYMBOL				
		KW	HP	VOLTAGE	PHASE	FLA	SPEED DRIVE	TYPE	NEMA SIZE	FURNISH BY	INSTALL BY	AUXIL. RELAY	LOCATION	TYPE	FURNISH BY	INSTALL BY	SWITCH/FUSE SIZE	LOCATION						TYPE	FURNISH BY	INSTALL BY	
FUR-1	FURNACE	-	-	120	1	12	-	SW	EC	EC	EC	EC	EC	NEAR UNIT	EC	EC	EC	15A	IN UNIT	HC	HC	HC	P1	9	(2) #12, (1) #12 CU GRD IN .75" C.	-	FUR-1

ABBREVIATIONS:
CC - CONTROL CONTRACTOR FS - FUSED SWITCH GC - GENERAL CONTRACTOR VC - VENTILATION CONTRACTOR
CP - CORD/PLUG FSC - FIRE SUPPRESSION CONTRACTOR HC - HEATING CONTRACTOR TS - THERMOSTAT
EC - ELECTRICAL CONTRACTOR FSEC - FOOD SERVICE EQUIP. CONTRACTOR PC - PLUMBING CONTRACTOR NFS - NON FUSED SWITCH
ES - EQUIPMENT SUPPLIER FVNR - FULL VOLTAGE NON-REVERSING SC - SPRINKLER CONTRACTOR SW - HORSEPOWER RATED SWITCH

NOTES:

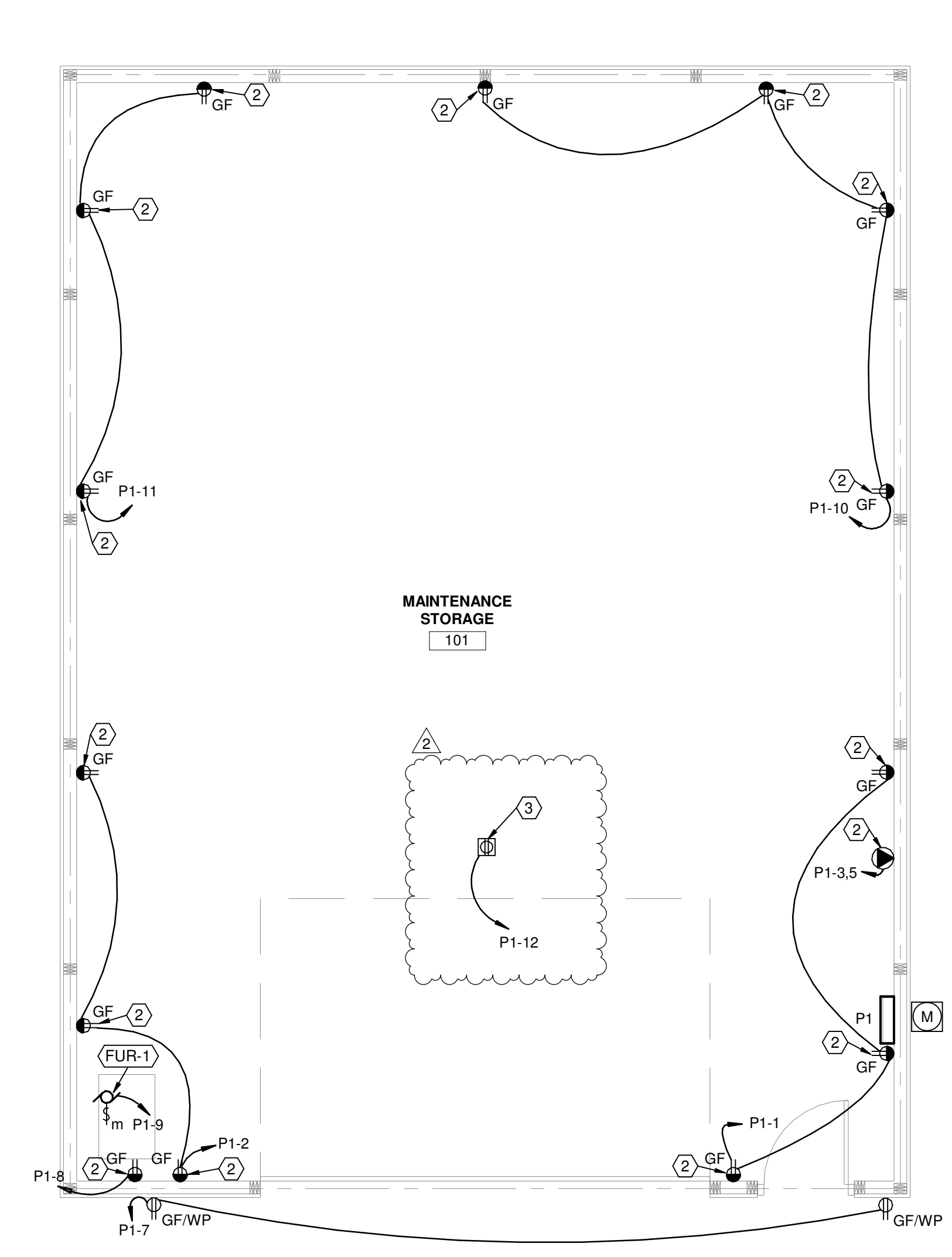

① POWER PLAN - NEW WORK
1/4" = 1'-0"

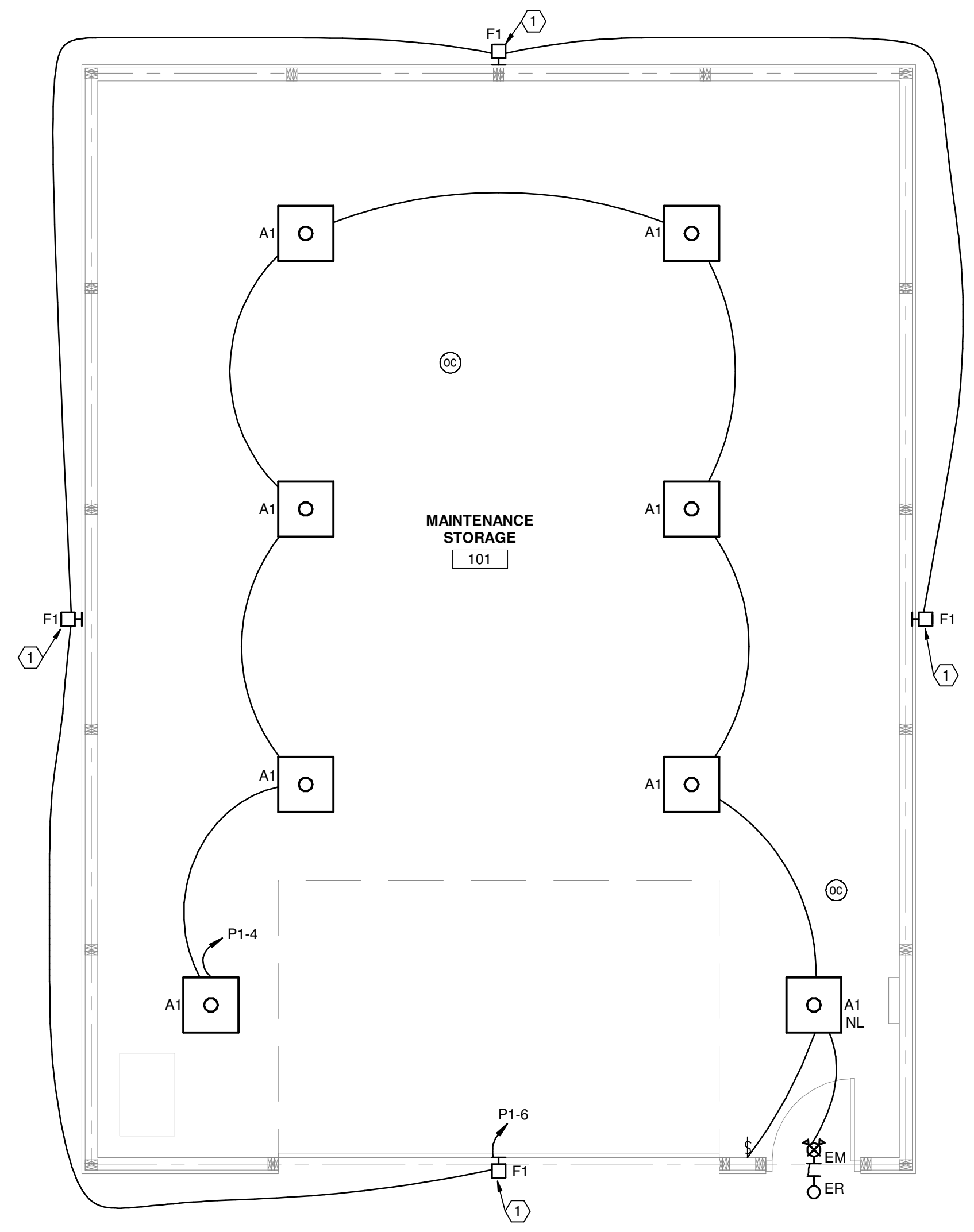

② LIGHTING PLAN - NEW WORK
1/4" = 1'-0"

Project Number	2024026
Date	February 27, 2026
Date	Issue
02.27.26	Bid/Construction Set
04.30.26	ADDENDUM #2
Sheet Title	POWER AND LIGHTING PLAN
Sheet Number	E1.1



Branch Panel: P1

Location: MAINTENANCE STORAGE 101 Volts: 120/208 Wye A.I.C. Rating:

Supply From: Phases: 3 Mains Type: MB

Mounting: Surface Wires: 4 Mains Rating: 100 A

Enclosure: Type 1 MCB Rating: 100 A

Notes:

CKT	Circuit Description	Trip	Poles	A	B	C	Poles	Trip	Circuit Description	CKT
1	RECPT-	20 A	1	540	540			1	20 A RECPT-	2
3	RECPT- MAINTENANCE STORAGE 101	35 A	2		2500	220		1	20 A LTG - OVER HEAD	4
5	--	--	--			2500	104	1	20 A LTG - WALL PACK	6
7	RECPT - GF/WP	20 A	1	360	180			1	20 A RECPT - FURNACE	8
9	FURNACE	15 A	1		1440	720		1	20 A RECPT - FURNACE	10
11	RECPT-	20 A	1			540	500	1	20 A OHD CEILING OUTLET ***	12
13	SPARE	20 A	1	0	0			1	20 A SPARE	14
15	SPARE	20 A	1					1	20 A SPARE	16
17	SPARE	20 A	1			0	0	1	20 A SPARE	18
19	SPARE	20 A	1	0	0			1	20 A SPARE	20
21	SPACE	--	1		--	--		1	-- SPACE	22
23	SPACE	--	1		--	--		1	-- SPACE	24
25	SPACE	--	1		--	--		1	-- SPACE	26
27	SPACE	--	1		--	--		1	-- SPACE	28
29	SPACE	--	1		--	--		1	-- SPACE	30
Total Load:				1620 VA	4880 VA	3644 VA				
Total Amps:				14 A	43 A	33 A				

Legend:

Load Classification	Connected Load	Demand Factor	Estimated Demand	Panel Totals
HVAC	1440 VA	100.00%	1440 VA	
Receptacle	8380 VA	100.00%	8380 VA	Total Conn. Load: 10144 VA
Lighting	324 VA	100.00%	324 VA	Total Est. Demand: 10144 VA
				Total Conn.: 28 A
				Total Est. Demand: 28 A

Notes:
*** - GROUND FAULT BREAKER

- ① FEEDER SCHEDULE
- ② (2) 3" CONDUITS FOR UTILITY CONDUCTORS
- ④ (4) #3 CU IN 1.5" C.

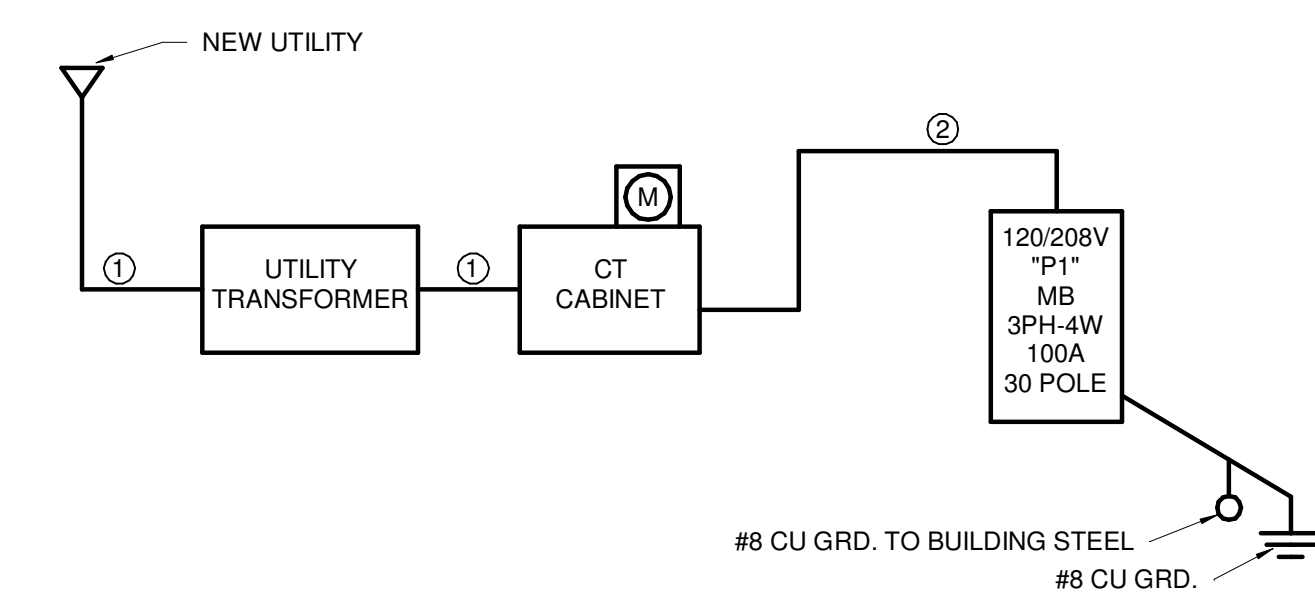

① SINGLELINE
NTS



Accessory Storage Building:
Mount Crest Court
 700 Mount Crest Court
 Dayton, Ohio 45403

Project Number	2024026
Date	February 27, 2026
Date	02.27.26
Issue	Bid/Construction Set
Date	04.30.26
ADDENDUM #2	

Sheet Title
 PANELBOARD
 SCHEDULES AND SINGLE
 LINE DIAGRAM

Sheet Number
E4.1