



## Wolfcreek Exhaust Fan Replacement Project

6055 Cotillion Court, Clayton Ohio 45315



If you would like to submit a bid, you must complete the GDPM Quote Form. It must be signed. If the proposal section does not have enough room for your proposal, please write 'see attached' and attach your quote.

If you are interested in working with GDPM, please contact [housingdevelopment@dmha.org](mailto:housingdevelopment@dmha.org) and request a vendor registration packet. Once submitted you will be notified of all contracting opportunities related to the areas you select when registering.

**PROJECT NAME:** *Wolfcreek Exhaust Fan Replacement Project Project*

**LOCATION:** 6055 Cotillion Court, Clayton Ohio 45315

Owner

Dayton Metropolitan Housing Authority dba  
Greater Dayton Premier Management  
400 Wayne Avenue Dayton, Ohio 45410

GDPM is seeking quotes for repairs at the abovementioned property. The work is referenced below and in the attached scope of work. Please include your quote in the "Contractor Proposal Price" box on the attached Request for Quote (RFQ) form or attach your proposal to the RFQ Form. The RFQ form must be signed and submitted.

**How to Quote:** Please provide overall quote for labor/material using the enclosed Request for Quote Form.

Email quotes to [housingdevelopment@dmha.org](mailto:housingdevelopment@dmha.org) **Questions:** Kevin Arnold at 937-910-7637

**Bid Deadline:** December 20, 2023 by 10:00 AM.



# PLANNING & DEVELOPMENT REQUEST FOR QUOTE

(THIS SECTION IS COMPLETED BY GDPM)

Job Name:

Contract #:

Scope:

Anticipated Project Term:

Anticipated Start Date

Prevailing Wage:

**Contractor:** Please indicate if any of the following contract award preference apply: (for more information on whether your company is eligible for any of the following preference categories, please go to <http://www.dmha.org/working-with-gdpm/doing-business-with-dmha/diversity.html>.)

Check at least one of the following ( If checked, please attach documentation):

Section 3

MBE/WBE

Veteran

None Apply

**Name of Business:**

**Street Address:**

**Street Address Line 2:**

**City:**

**State:**

**Zip Code:**

**Contact Number:**

**E-mail:**

Contractor's Proposal & Price:

By signing below, Contractor acknowledges that if selected for the Contract Award, Contractor will perform all work necessary to complete the task as specified above at Contractor's quoted price within the time period provided. Further, Contractor has reviewed and accepts all GDPM Small Construction General Terms and Conditions and, unless otherwise specified in writing by GDPM, no other contract documents will be necessary. A copy of all GDPM Required Contract Documents is available at <http://www.dmha.org/RAD/contract-documents.html> or upon request by e-mailing at [housingdevelopment@gdpm.org](mailto:housingdevelopment@gdpm.org).

\_\_\_\_\_  
Contractor Signature of Acceptance

\_\_\_\_\_  
Date

**Acceptance of Proposal:**

The above price, specifications, and conditions are satisfactory and are hereby accepted. You are authorized to do the work as specified.

\_\_\_\_\_  
GDPM Signature of Acceptance

\_\_\_\_\_  
Date

\_\_\_\_\_  
Project Start Date

Replace exhaust fans with Boran 678 fan-light unit or equal, replace exhaust duct (4 inch flex or rigid pipe). Install 60 watt Ecosmart A19 LED light bulbs. This includes upper bathroom and half bathroom on ground level for the fans. Re-use existing wiring and switches. There are 35 units on site, two fan-light units per apartment is 70 units, 70 light bulbs. The contractor shall contact Kevin Arnold 937-910-7637 karnold@dmha.org to make arrangements to visit the site in order to determine quantities for duct material. 90 percent of units are occupied. The contractor shall repair any drywall damage to the ceiling and paint the ceiling to match the existing color.



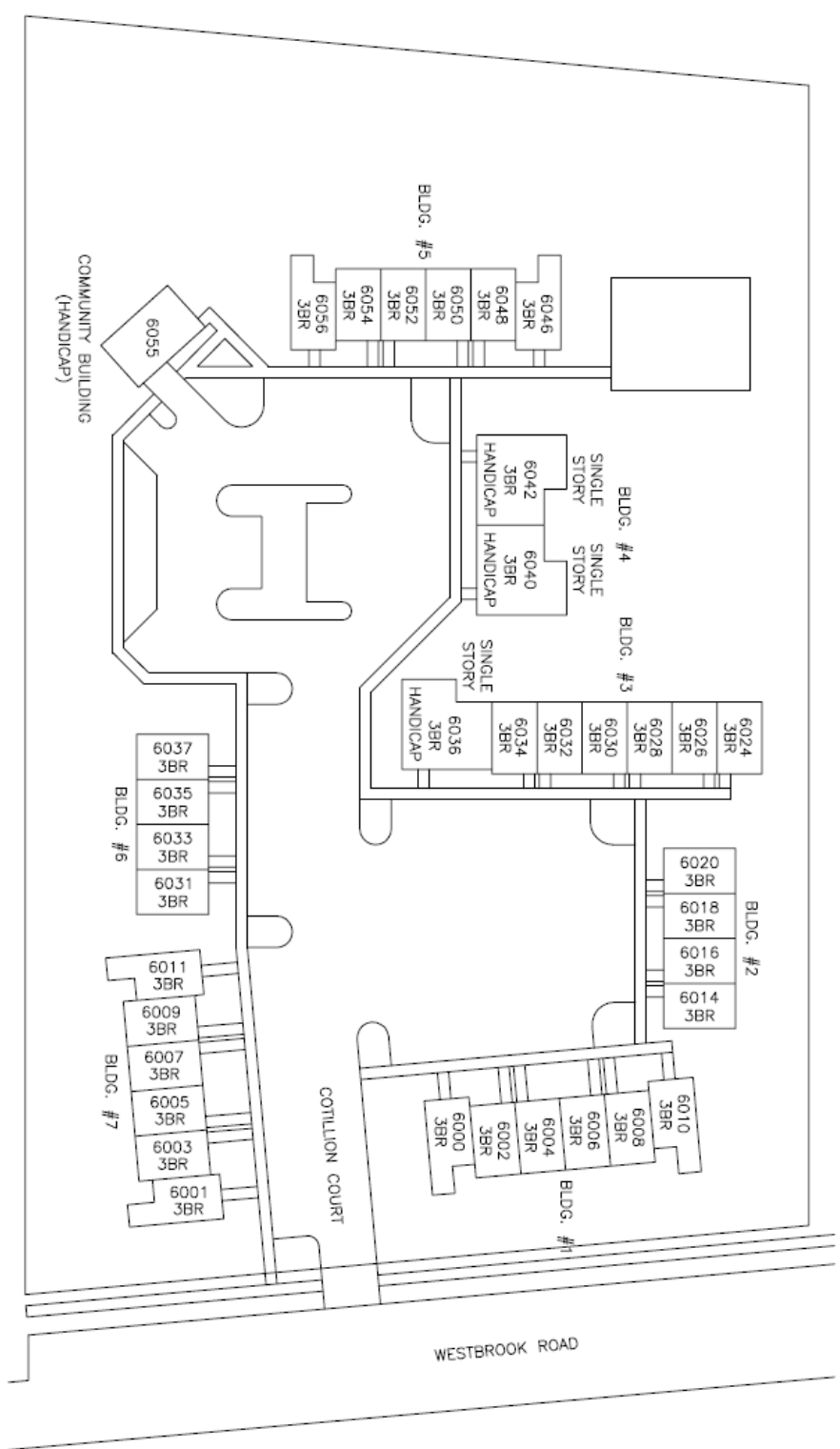

NOTE:  
 6-BUILDINGS - BUILDINGS #1, 2, 3 (EXCEPT 6036), 5, 6 & 7 (2-STORY, TOWNHOUSES)  
 32-UNITS  
 1-BUILDING - BUILDING #4 & UNIT 6036 (1-STORY, HANDICAP)  
 3-UNITS



**WOLF CREEK HOMES**

4.29 ACRES  
 187,300 SQ. FT.

Wolf Creek Homes OH5-53		6055 Cottillion Court
DATE	3-24-05	
DRAWN BY		
CHECKED BY		
SHEET	M-4000	

## MODELS 678 & 679 FAN/LIGHTS

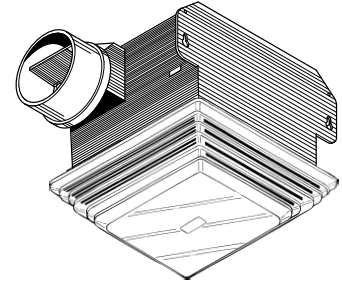

Quality and double-duty at each installation location.

### FEATURES

#### GRILLE:

- Matte white polymeric - blends well with any decor
- Built-in light-diffusing lens accepts up to 100 W incandescent lamp. Bulb not included.

#### BLOWER:

- Plug-in, permanently lubricated motor
- Polymeric blower wheel

#### HOUSING:

- Rugged, 26-gage galvanized steel construction
- Sturdy key-holed mounting brackets for quick, accurate installation
- Tapered, polymeric duct fitting with built-in backdraft damper for easy, positive duct connection and no metallic clatter

**Model 2677H:** Rough-in housing for 2678F finish assembly (packed 4 per carton).

NOTE: For installation in ceilings up to a 12/12 pitch.

cULus Listed for use in insulated ceilings (Type I.C.)

cULus Listed for use over bathtubs and showers when connected to a GFCI protected branch circuit

Use supply wiring rated for at least 90°C

### SPECIFICATIONS

Model	Ps (in. w.g.)	CFM	Sones	CFM/W	Amps*	Volts	Duct Size
678	0.1	50	2.5	1.4	1.6	120	4" Round
	0.25	31	3.0	0.8			
679	0.1	70	3.5	1.0	2.0		
	0.25	63		0.9			

\*Total Connected Load



HVI-2100 CERTIFIED RATINGS comply with new testing technologies and procedures prescribed by the Home Ventilating Institute, for off-the-shelf products, as they are available to consumers. Product performance is rated at 0.1 in. static pressure, based on tests conducted in a state-of-the-art test laboratory. Sones are a measure of humanly-perceived loudness, based on laboratory measurements.

Broan-NuTone LLC, 926 West State Street, Hartford, Wisconsin USA 53027 Broan-NuTone.com 800-558-1711

Venmar Ventilation ULC, 550 Lemire Blvd., Drummondville, Québec, Canada J2C 7W9 Broan-NuTone.ca 800-567-3855

### TYPICAL SPECIFICATION

Fan/Light unit shall be Broan Model 678 (679).

Unit shall have galvanized steel housing with dual integral mounting brackets. It shall be ducted to a roof or wall cap.

Blower assembly shall be removable and have a permanently lubricated motor.

Air delivery shall be no less than and sound level no greater than values listed in the "Specifications" chart below. Air and sound ratings shall be certified by HVI.

Lamp shall be 100W maximum incandescent.

Unit shall be U.L. Listed for use over bathtubs and showers when connected to a GFCI protected branch circuit.

Unit shall be cULus for use in insulated ceilings (Type I.C.).

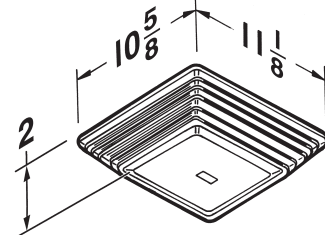
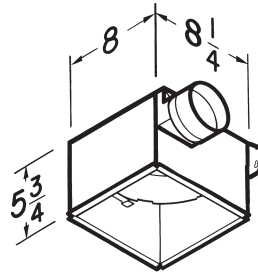

Dimensions shown are in inches.

REFERENCE	QTY.	REMARKS	Project
			Location
			Architect
			Engineer
			Contractor
			Submitted by Date

# VENTILATEURS/LUMINAIRES MODÈLES 678 ET 679

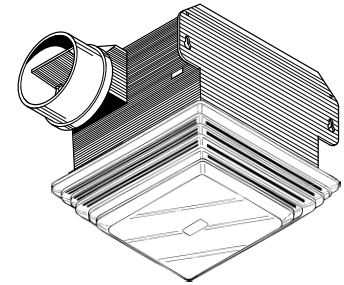

**Qualité et double fonction à chaque lieu d'installation.**

### CARACTÉRISTIQUES

#### GRILLE:

- Polymère blanc mat, s'agence à tous les décors
- Réflecteur intégré accepte une ampoule incandescente pouvant aller jusqu'à 100 W. Ampoule non comprise.

#### VENTILATEUR:

- Enfichable, lubrifié à vie
- Roue du ventilateur en polymère

#### BOÎTIER:

- Construction solide en acier galvanisé de calibre 26
- Brides de montage solides munies de trous en forme de serrure pour une installation rapide et précise
- Raccord de conduit conique en polymère avec clapet intégré pour un raccordement sûr et facile au conduit, sans cliquetis métallique

**Modèle 2677H:** Ensemble de boîtiers pour projets à utiliser avec les ensembles de finition 2678F (emballage de 4 par boîte).

**NOTE:** Pour une installation dans les plafonds ayant jusqu'à 12/12 de pente.

Homologué cULus pour une utilisation sur un plafond isolé (Type I.C.)

Homologué cULus pour une utilisation au-dessus de la baignoire et de la douche lorsqu'il est raccordé à un circuit protégé par un disjoncteur de fuite à la terre (DDFT)

Utiliser un câble électrique pouvant résister à au moins 90 °C

### SPÉCIFICATIONS

Modèle	Ps (po d'eau)	pi <sup>3</sup> /min	Sones	pi <sup>3</sup> /min/W	A*	Volts	Format de conduit
678	0,1	50	2,5	1,4	1,6	120	4 po rond
	0,25	31	3,0	0,8			
679	0,1	70	3,5	1,0	2,0		
	0,25	63		0,9			

\*Charge totale connectée

### SPÉCIFICATION TYPE

Le ventilateur/luminaire doit être de modèle 678 de Broan (679).

L'appareil doit avoir un boîtier en acier galvanisé avec deux brides de montage intégrées. Son conduit doit être relié à un évent de toit ou mural.

Le bloc moteur doit être amovible et avoir un moteur lubrifié à vie.

Le débit de l'air ne doit pas être inférieur et le niveau sonore ne doit pas dépasser les données listées dans le tableau de Spécifications ci-dessous. Les données sur le débit d'air et le niveau sonore doivent être certifiées par le HVI.

L'ampoule incandescente doit être d'un maximum de 100 W. L'appareil doit être homologué cULus pour une utilisation au-dessus de la baignoire et de la douche lorsqu'il est raccordé à un circuit protégé par un disjoncteur de fuite à la terre (DDFT)

Homologué cULus pour une utilisation sur un plafond isolé (Type I.C.)

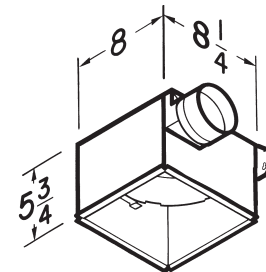

Les dimensions illustrées sont en pouces.

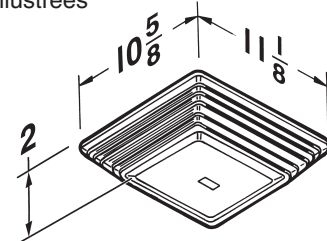

RÉSULTATS HOMOLOGUÉS HVI-2100 conforme aux nouvelles technologies de test et aux procédures prescrites par le Home Ventilating Institute pour les produits offerts sur le marché, tels qu'ils sont présentés aux consommateurs. La performance du produit est calibrée à 0,1 po de pression statique, basée sur les tests dirigés par un laboratoire de pointe. Un sone est une unité de mesure de bruit perçu par l'oreille humaine, basée sur des mesures en laboratoire.

Broan-NuTone LLC, 926 West State Street, Hartford, Wisconsin USA 53027 Broan-NuTone.com 800 558-1711  
Venmar Ventilation ULC, 550 Lemire Blvd., Drummondville, Québec, Canada J2C 7W9 Broan-NuTone.ca 800 567-3855

RÉFÉRENCE	QTÉ	REMARQUES	Projet
			Lieu
			Architecte
			Ingénieur
			Entrepreneur
			Soumis par <span style="float: right;">Date</span>