

# **RFP 22-01**

Section 18 Needs Assessments

## **PROPERTY INFORMATION**

Site Name	Units	Site Address	O BR	1 BR	2 BR	3 BR	4 BR	5 BR	Dwelling Buildings	Non-Dwelling Buildings	Construction Date	DOFA DATE	Acres
138 Gettysburg	5	138 N. Gettysburg Avenue, 45417			5				1		1975	7/31/1975	0.18
Winters	6	436-440 Winters Street, 45417		6					2		1970	4/1/1970	0.09
Superba	24	3004-3005 Superba			20	4			2		1970	8/1/1970	0.97
Willow	6	619 Willow Street		6					1		1970	4/1/1970	0.19
Wilkinson Plaza	200	126 W. Fifth Street		199	1				1		1964	8/1/1964	0.98
DeSoto Bass 1	226	811 Oldfield Avenue		78	100	36	12		24	2	1942	3/1/1942	25.894
DeSoto Bass 2	128	811 Oldfield Avenue		12	85	31			19	3	1953	12/1/1953	
Hoch	6	261 Hoch		6					1		1970	4/1/1970	0.15

H:\5209\5209-M24.dwg, 05/05/2004 10:56:26 AM, Eric E.J.N. 5209-M24.dwg  
 E.J.N. 5209-A24.dwg  
 4-24-04 11:51:47 5-4-04 13:30:01 5-5-04 10:56:19



NOTE:  
 1-BUILDING - BLDG. #1 (GARDEN APARTMENTS)  
 3-UNITS - 261, 263, 265 HOCH STREET (ELDERLY)  
 3-UNITS - 267 HOCH STREET - APARTMENTS A, B & C (ELDERLY)

**SITE PLAN**

SCALE: 1" = 60'-0"

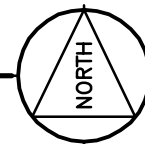

**HOCH STREET**

.15 ACRES  
 6,700 SQ. FT.

**Helmig Lienesch & Associates**  
 Consulting Engineers  
 1660 Kettering Tower  
 Dayton, Ohio 45423  
 (937) 228-4007  
 FAX: (937) 228-1936

**Hoch Street OH5-18D**  
 for  
**DMHA**  
 Dayton, Ohio

261 Hoch Street

DATE  
 4-12-04

DRAWN BY  
 E.J.N.

CHECKED BY  
 DRH

SHEET  
**M-2100**

H:\5209\5209-M15.dwg, 05/05/2004 10:51:32 AM, Eric E.JN 5209-M15.dwg  
 E.JN 5209-TB17X1.dwg 5-4-04 1:34:56  
 4-24-04 11:51:47

WEBSTER STREET

EARL AVENUE

NORTH KEOWEE STREET

ALLEY

TAYLOR STREET

WILLOW STREET

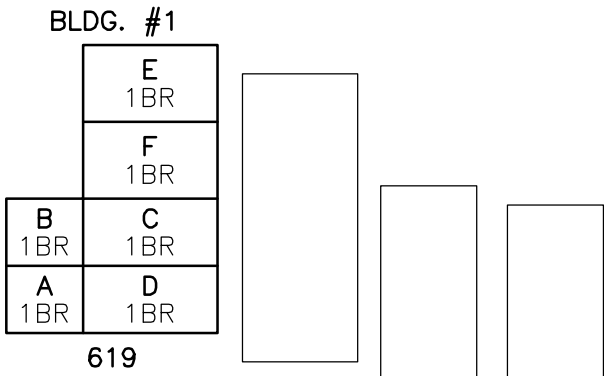

NOTE:  
 1-BUILDING  
 6-UNITS (ELDERLY)

**SITE PLAN**

SCALE: 1" = 50'-0"

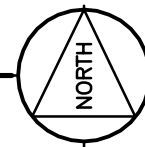

619 WILLOW STREET

.19 ACRES  
 8,300 SQ. FT.

619 Willow Street OH5-18F  
 for  
 DMHA

Dayton, Ohio

619 Willow Street

DATE  
 4-12-04

DRAWN BY  
 E.JN

CHECKED BY  
 DRH

SHEET  
 M-3300

Helmig Lienesch & Associates  
 Consulting Engineers

1660 Kettering Tower  
 Dayton, Ohio 45423  
 (937) 228-4007  
 FAX: (937) 228-1936

EJN 5322-TB17X11.dwg 3-2-05 15:37:39  
 EJN 5322-A2-5309.dwg 3-7-05 10:03:28  
 EJN 5322-M2-5309.dwg 3-7-05 10:04:19

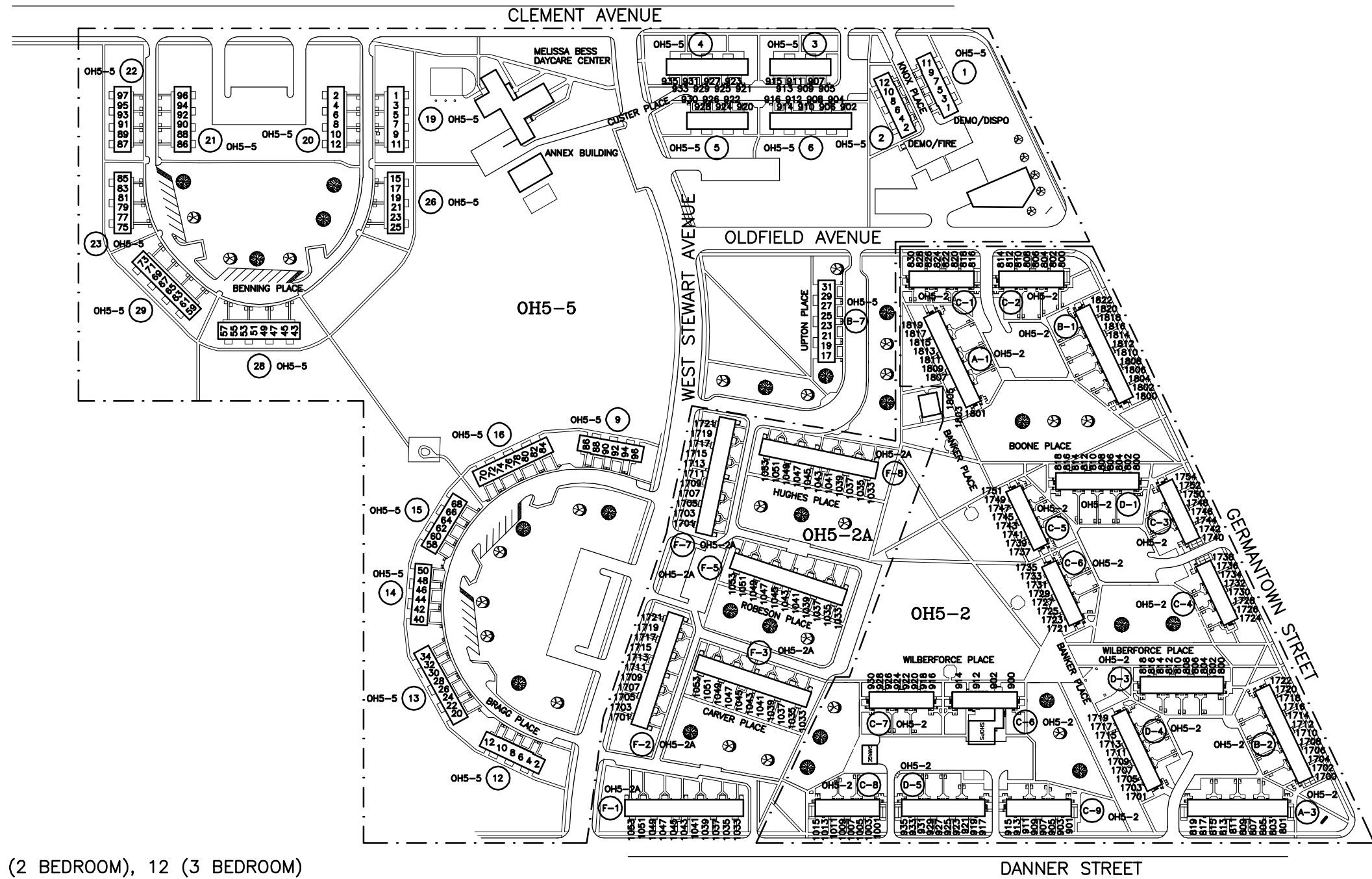

NOTE:  
 OH5-2  
 18-BUILDINGS  
 160-UNITS (FAMILY) 72 (1 BEDROOM), 76 (2 BEDROOM), 12 (3 BEDROOM)

OH5-2A  
 6-BUILDINGS  
 66-UNITS (FAMILY) 6 (1 BEDROOM), 24 (2 BEDROOM), 24 (3 BEDROOM), 12 (4 BEDROOM)

OH5-5  
 20-BUILDINGS  
 132-UNITS (FAMILY) 16 (1 BEDROOM), 85 (2 BEDROOM), 31 (3 BEDROOM)

TOTAL:  
 44-BUILDINGS (INCLUDING 1 SENIOR CITIZENS BUILDING)  
 358-UNITS (FAMILY)

**SITE PLAN**

SCALE: 1" = 200'-0"

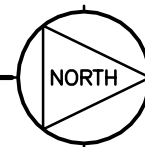

**DESOTO BASS COURTS**

45.52 ACRES	33.35 ACRES
1,987,000 SQ. FT.	1,455,600 SQ. FT.
(AREA SOUTH OF W. STEWART INCLUDED)	(AREA SOUTH OF W. STEWART NOT INCLUDED)

DMHA Desoto Bass Courts OH5-2/2A/5

811 Oldfield Avenue

Dayton, Ohio

**Helmig Lienesch LLC**  
 Consulting Engineers

1660 Kettering Tower  
 Dayton, Ohio 45423  
 (937) 228-4007  
 FAX: (937) 228-1996

DATE  
 3-4-05

DRAWN BY  
 EJN

CHECKED BY  
 DRH

SHEET  
 M-4500

H:\5309\5309-M6.dwg, 12/29/2004 01:42:50 PM, Eric E.JN 5309-M6.dwg 12-29-04 13:42:44  
 E.JN 5309-A6.dwg 11-24-04 13:45:22  
 12-13-04 12:55:46

NOTE:  
 HI-RISE  
 14 STORIES  
 1-BUILDING  
 200-UNITS (ELDERLY) 199 (1 BEDROOM), 1 (2 BEDROOM)

WILKINSON STREET

WEST FIFTH STREET

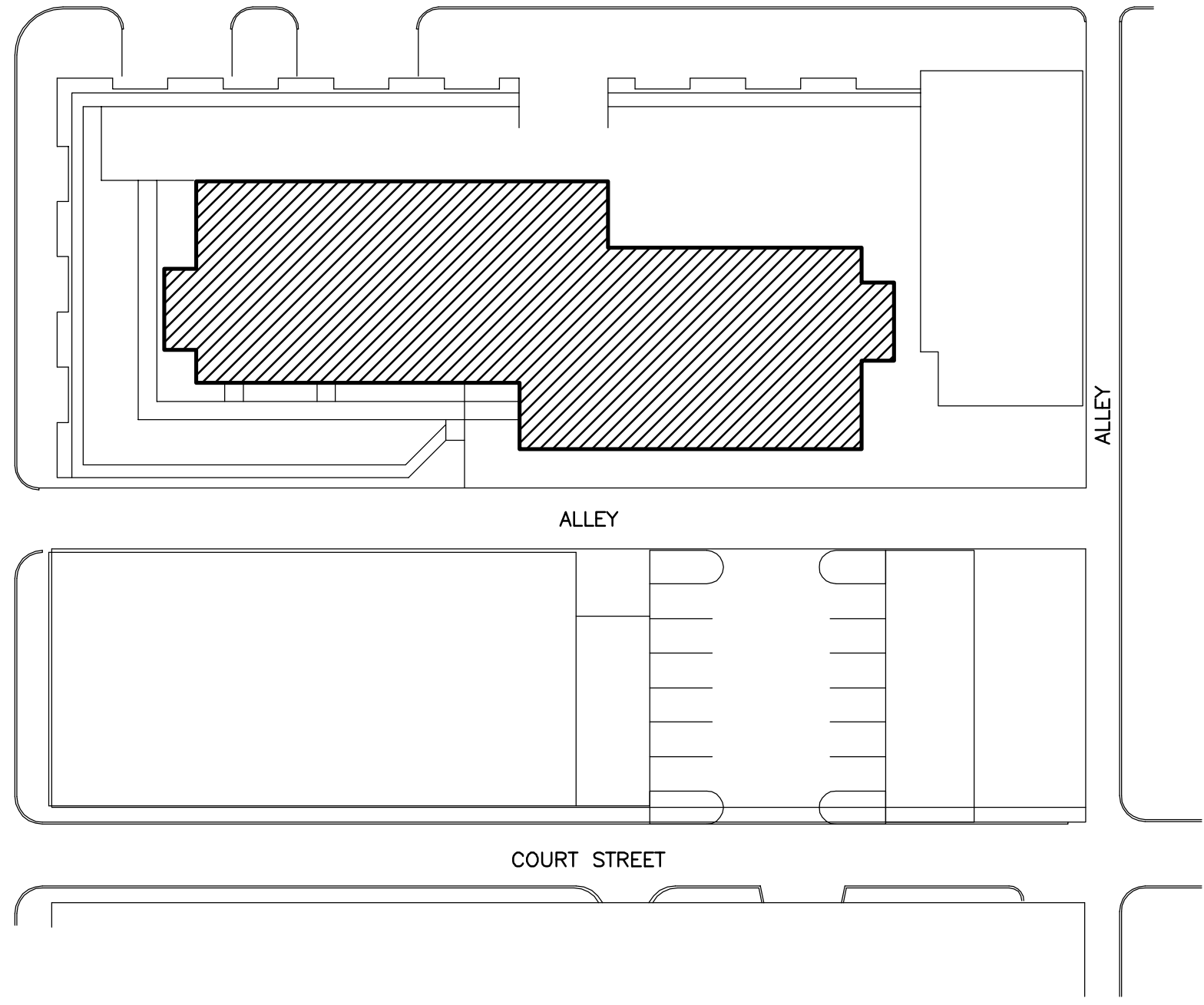

ALLEY

ALLEY

COURT STREET

**SITE PLAN**

SCALE: 1" = 40'-0"

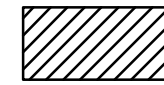
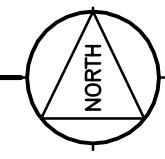

HI RISE

**WILKINSON PLAZA**

0.76 ACRES	0.98 ACRES
33,300 SQ. FT.	43,000 SQ. FT.
(PARKING LOT NOT INCLUDED)	(PARKING LOT INCLUDED)

DATE	12-10-04
DRAWN BY	EJN
CHECKED BY	DRH
SHEET	M-400

Wilkinson Plaza OH5-10  
 for  
 DMHA

126 West Fifth Street

Dayton, Ohio

Helmig Lienesch & Associates  
 Consulting Engineers

1660 Kettering Tower  
 Dayton, Ohio 45423  
 (937) 228-4007  
 FAX: (937) 228-1936

H:\5300\5316\5316-M14.dwg, 02/18/2005 10:40:29 AM, Eric  
 E:\5316-1B17\1.dwg E:\5316-A14.dwg  
 2-18-05 10:24:44 2-18-05 10:40:23

NOTE:  
 2-BUILDINGS  
 6-UNITS (ELDERLY) (1 BEDROOM)

**SITE PLAN**  
 SCALE: 1" = 50'-0"

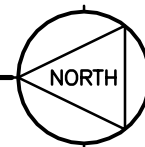

436-440 WINTERS

0.09 ACRES  
 3,800 SQ. FT.

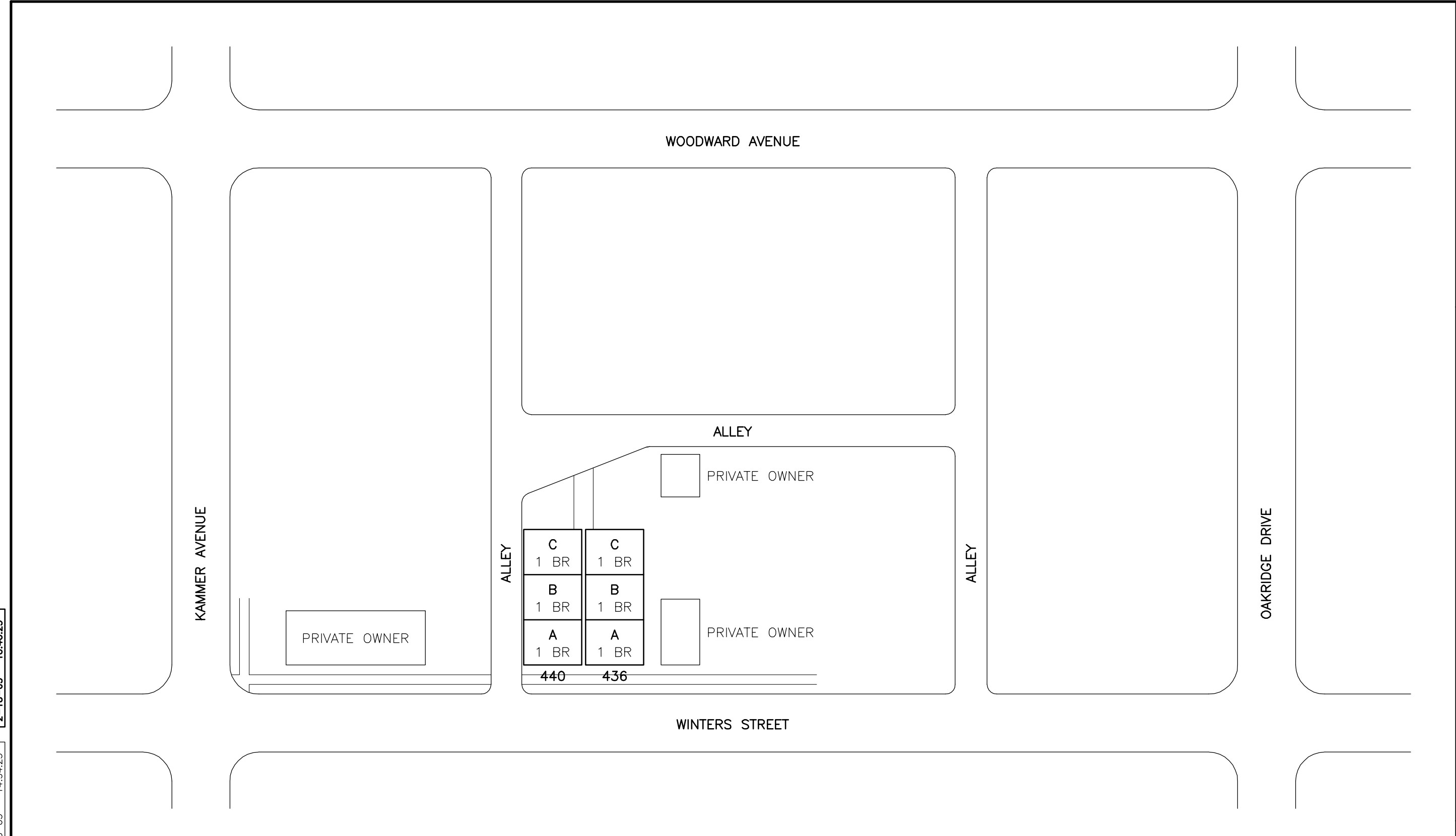

DATE  
 1-31-05

DRAWN BY  
 EJN

CHECKED BY  
 DRH

SHEET  
 M-5900

DMHA 436-440 Winters OH5-18E

440 Winters Street

Dayton, Ohio

**Helmig Lienesch LLC**  
 Consulting Engineers

1660 Kettering Tower  
 Dayton, Ohio 45423  
 (937) 228-4007  
 FAX: (937) 228-1996

H:\5209\5209-M15.dwg, 05/05/2004 10:51:32 AM, Eric E.JN 5209-M15.dwg  
 E.JN 5209-TB17X1.dwg 5-4-04 1:34:56  
 4-24-04 11:51:47

WEBSTER STREET

EARL AVENUE

NORTH KEOWEE STREET

ALLEY

TAYLOR STREET

WILLOW STREET

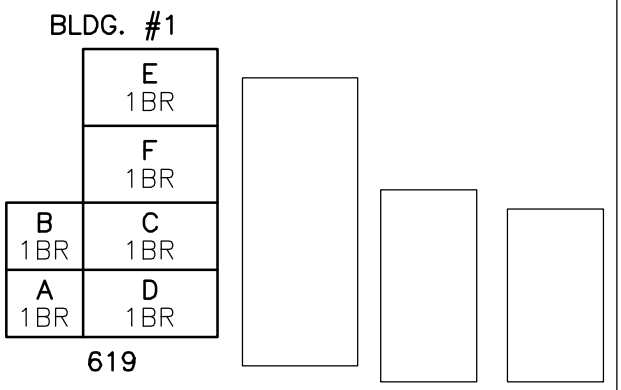

NOTE:  
 1-BUILDING  
 6-UNITS (ELDERLY)

**SITE PLAN**

SCALE: 1" = 50'-0"

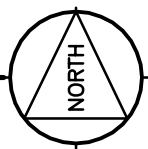

619 WILLOW STREET

.19 ACRES  
 8,300 SQ. FT.

DATE  
 4-12-04

DRAWN BY  
 E.JN

CHECKED BY  
 DRH

SHEET  
 M-3300

619 Willow Street OH5-18F  
 for  
 DMHA

619 Willow Street

Dayton, Ohio

Helmig Lienesch & Associates  
 Consulting Engineers

1660 Kettering Tower  
 Dayton, Ohio 45423  
 (937) 228-4007  
 FAX: (937) 228-1936



H:\5300\5309\5309-M9.dwg, 12/29/2004 01:44:25 PM, Eric E.JN 5309-M9.dwg  
 E.JN 5309-TB17X1.dwg E.JN 5309-A9.dwg 12-29-04 13:44:19  
 12-13-04 12:55:46

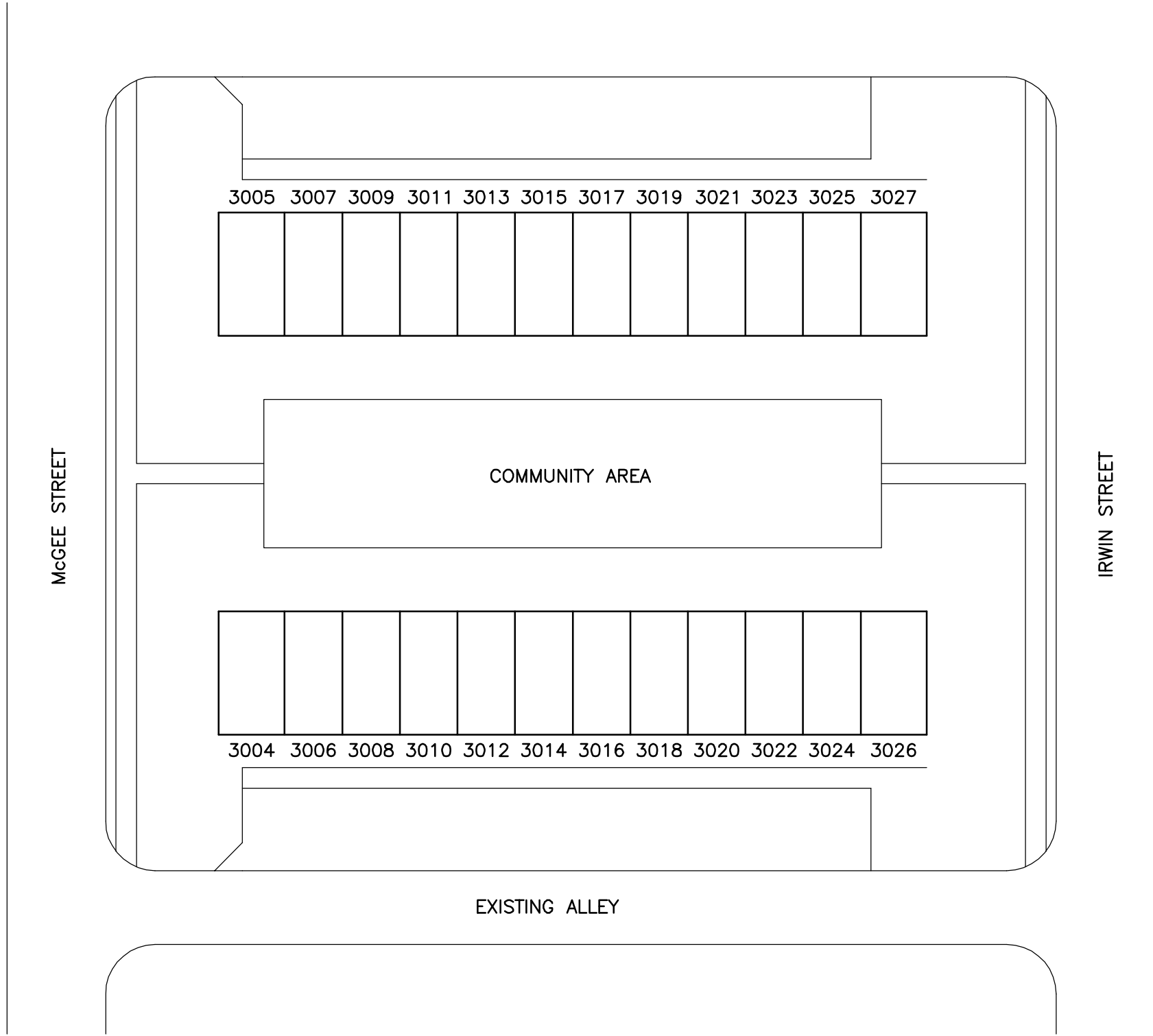

NOTE:  
 2-BUILDINGS  
 24-UNITS (FAMILY)

**SITE PLAN**  
 SCALE: 1" = 32'-0"

**SUPERBA COURT**

0.97 ACRES  
 42,500 SQ. FT.

<b>Helmig Lienesch &amp; Associates</b> Consulting Engineers 1660 Kettering Tower Dayton, Ohio 45423 (937) 228-4007 FAX: (937) 228-1936	
<b>Superba Court OH5-19</b> for <b>DMHA</b>	Dayton, Ohio 3004 Superba Court
DATE	12-10-04
DRAWN BY	RLH/EJN
CHECKED BY	DRH
SHEET	M-1000